

TOWNSHIP 35 N., RANGE 4 E.W.M. SKAGIT COUNTY

CHAS. F. METSKER CIVIL ENGINEER
930 1/2 PAC. AVE. TACOMA, WASH.

16

SCALE 2 IN. = 1 MILE.

DATED DEC. 1925.

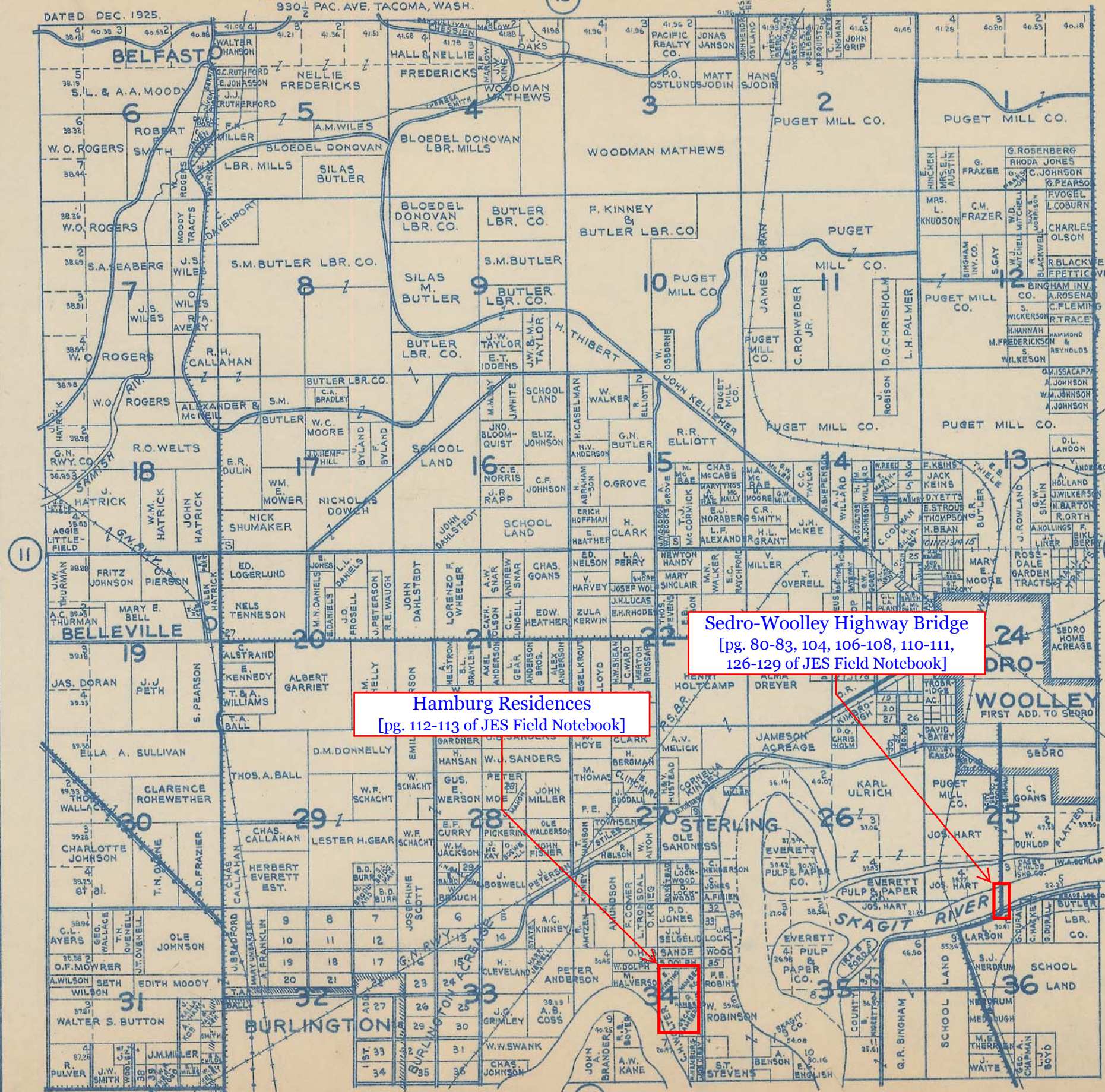

- 1- R.H. CALLAHAN
- 2- W.M. OSBORNE
- 3- SWANBY
- 4- OLE BIERBERN
- 5- SHOLUND
- 6- C. SHELTON
- 7- J. SMITH
- 8- W.R. DUNCON
- 9- S. RAYMENT
- 10- T. PHIPPS
- 11- "
- 12- BINGHAM INV. CO.
- 13- A.V. LARSON
- 14- M. RAE
- 15- W. O'NEILL
- 16- J. HAMEL
- 17- SKAGIT CO.
- 18- A. HALBERG
- 19- W.M. LE FAYEUR
- 20- JOHN ROWLAND
- 21- W.B. SARGENT
- 22- JOHN LAVIN
- 23- S. BJERSTADT
- 24- E. HAMIL
- 25- W. STOHR
- 26- JULIUS SCHOLICH
- 27- G.D. PIERSON
- 28- SKAGIT CO.
- 29- R. NELSON
- 30- DAVID ROSS
- 31- A. ROSS
- 32- L.R. FINSON
- 33- A. HOFFMAN
- 34- C. BRIDER
- 35- O. HAMBERG
- 36- L. JACKSON
- 37- JAS. JORDAN
- 38- W. ANDERSON
- 39- C. ROHWEDER

Sedro-Woolley Highway Bridge
 [pg. 80-83, 104, 106-108, 110-111,
 126-129 of JES Field Notebook]

Hamburg Residences
 [pg. 112-113 of JES Field Notebook]

- LEGEND -
- MAIN TRAVELED HWYS.
 - PAVED ROADS
 - OTHER ROADS
 - TRAILS
 - RAILROADS
 - ELE. RWYS.
 - SCHOOLS

TOWNSHIP 35 N., RANGE 5 E.W.M. SKAGIT COUNTY

CHAS. F. METSKER CIVIL ENGINEER
930 1/2 PAC. AVE. TACOMA, WASH.

(20)

SCALE 2 IN = 1 MILE.

DATED DEC. 1925.

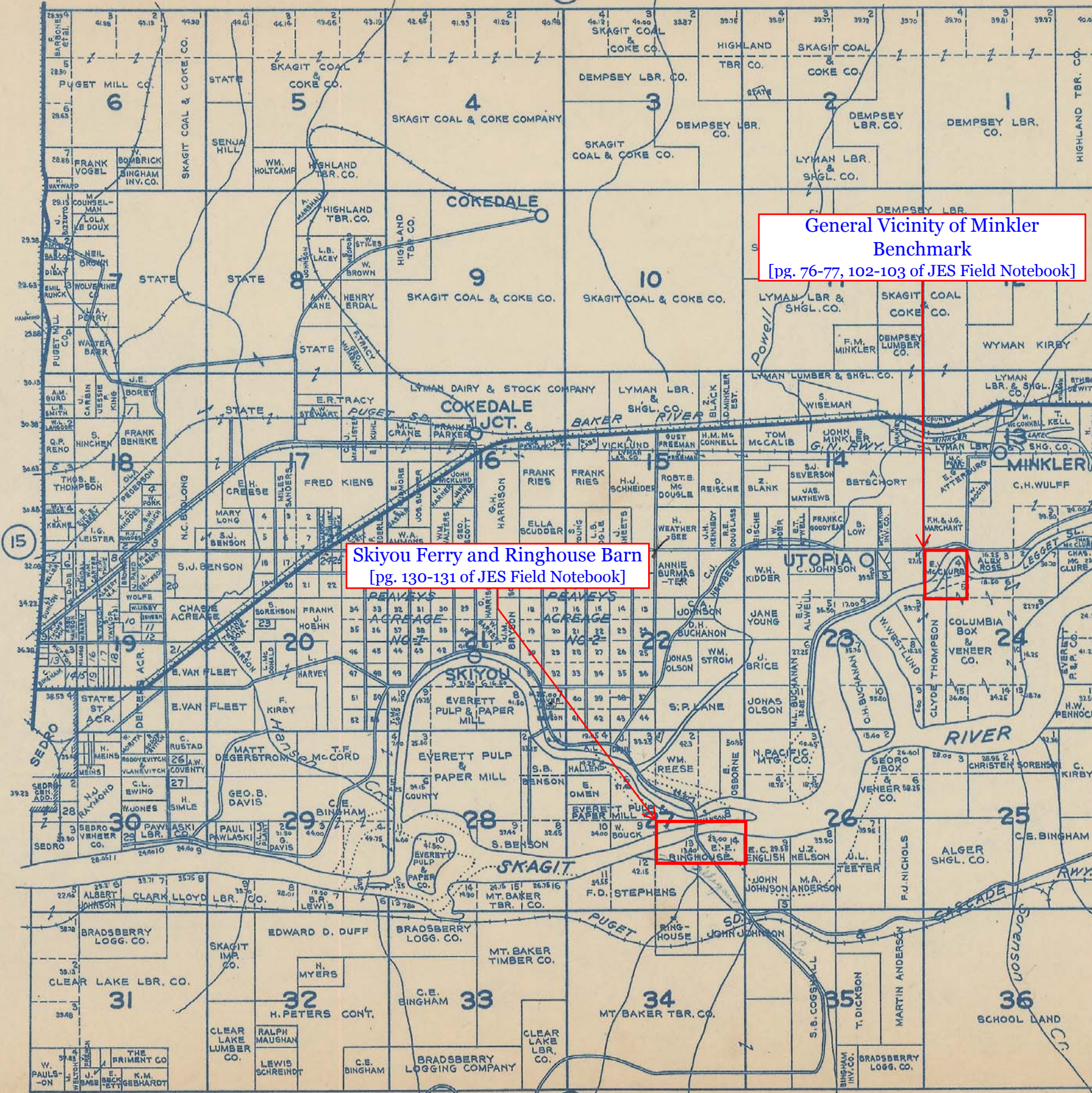

General Vicinity of Minkler
Benchmark
[pg. 76-77, 102-103 of JES Field Notebook]

Skiyou Ferry and Ringhouse Barn
[pg. 130-131 of JES Field Notebook]

- 1 - W.W. JORDAN
- 2 - C.C. RIDGES
- 3 - V.G. ROSUACQUES
- 4 - SOMMERVILLE
- 5 - C.E. BINGHAM
- 6 - JAS. STEWART
- 7 - C. GASTRICH
- 8 - H.H. WELLES
- 9 - C.A. WICKER
- 10 - J.C. ANDERSON
- 11 - PETER ANDERSON
- 12 - F.L.A. ROCHE
- 13 - O. BINGHAM
- 14 - P. HAMILTON
- 15 - MAGGIE HENLEY
- 16 - M.M. MAHON
- 17 - F.C. HANDY
- 18 - J. WALLS
- 19 - P. HAMILTON
- 20 - R.E. MATSFIELD
- 21 - S. POW. & LT. CO.
- 22 - E.M. TALBERT
- 23 - JAS. FESSLER
- 24 - U.R. MORELOCK
- 25 - T.W. BROWN
- 26 - G. ESTES
- 27 - JAS. WALTZ
- 28 - B. TINGLEY

- PEAVEYS ACR.-1-**
- | | |
|-------------------|-----------------------|
| M. HESKITT | LOT'S 2, 7, & 43, 6. |
| H. LOHSE | " 17, 5 & W 1/2 3, 6. |
| I. CANDLER | " 18 |
| E.M. TALBERT | " 19 |
| R. THARP | " 20 |
| W. HESKETT (Part) | " 16 |
| L.M. MORGAN | " 21, 22. |
| W.M. KAHLE | " 13, 14. |
| JOHN RAYMENT | " 12, 23, 25. |
| AMON HENDRICKSON | " 24 |
| S. SMITH | " 34, 35. |
| E.M. DANNE MILLER | " 33, 36. |
| F. HOCHN | " 46 |
| E. BROSSARD | " 45 |
| A.J. WOLSEGEL | " 48 |
| ADAM WOLSEGEL | " 50, 51. |
| C.A. HARVEY | " 47 |
| J.M. HARRISON | " 52, 53. |
| A.J. EASLEY | " 11, 26. |
| A.J. TAYLOR | " 31, 32. |
| EMIL WERSON | " 9, 10, 27, 28. |
| E.M. FENDER | " 30, 39, 42. |
| W.M. BOCH | " 38, 43. |
| E.J. BART | " 44 |
| M. PELTON | " 49 |
| GREEN SHINGLE | " 49 |
| R. DIETZ | " 29, 40 |

- PEAVEYS ACR.-2-**
- | | |
|------------------|-------------------|
| FRED BACUS | LOTS 6, 5 |
| F.H. CHASE | " 4 |
| W.H. OGLE | " 2, 9, 10, 11. |
| PETER OLSEN | " 7, 12, 13. |
| C.D. KIRK | " 8, 9. |
| KNUT ANDERSON | " 18, 19, 30, 31. |
| ANDREW OLSON | " 17, 20. |
| JOHN JOHNSON | " 29, 32. |
| U.J. RONNING | " 15, 16, 21. |
| W.H. GALOS | " 22. |
| KNUT ANDERSON | " 23. |
| C.E. STAFFER | " 27, 28, 33, 34. |
| J.H. HALLER | " 40, 41. |
| G. ERICKSON | " 39, 42, 43, 38. |
| ALFRED MAGNUSSEN | " 26, 35. |
| H. NELSON | " 43. |
| PETER BROCKMAN | " 44, 54, 58. |
| ANNIE EVANS | " 37. |
| C.P. HUISE | " 36. |
| ED. SUMMERS | " 36. |
| GEO. JAMES | " 25. |
| HANS JENSEN | " 24. |

- LEGEND -**
- MAIN TRAVELED HWYS.
 - PAVED ROADS
 - OTHER ROADS
 - TRAILS
 - RAILROADS
 - ELE. RWYS.
 - SCHOOLS

TOWNSHIP 35 N., RANGE 6 E.W.M. SKAGIT COUNTY

DATED DEC. 1925.

CHAS. F. METSKER CIVIL ENGINEER
930 1/2 PAC. AVE. TACOMA, WASH.

SCALE 2 IN = 1 MILE.

- 1- FRED PRICE
- 2- H. HENRICKSON
- 3- MARTHA DAVIES
- 4- MT. BAKER TBR. CO.
- 5- L. MEDFORD

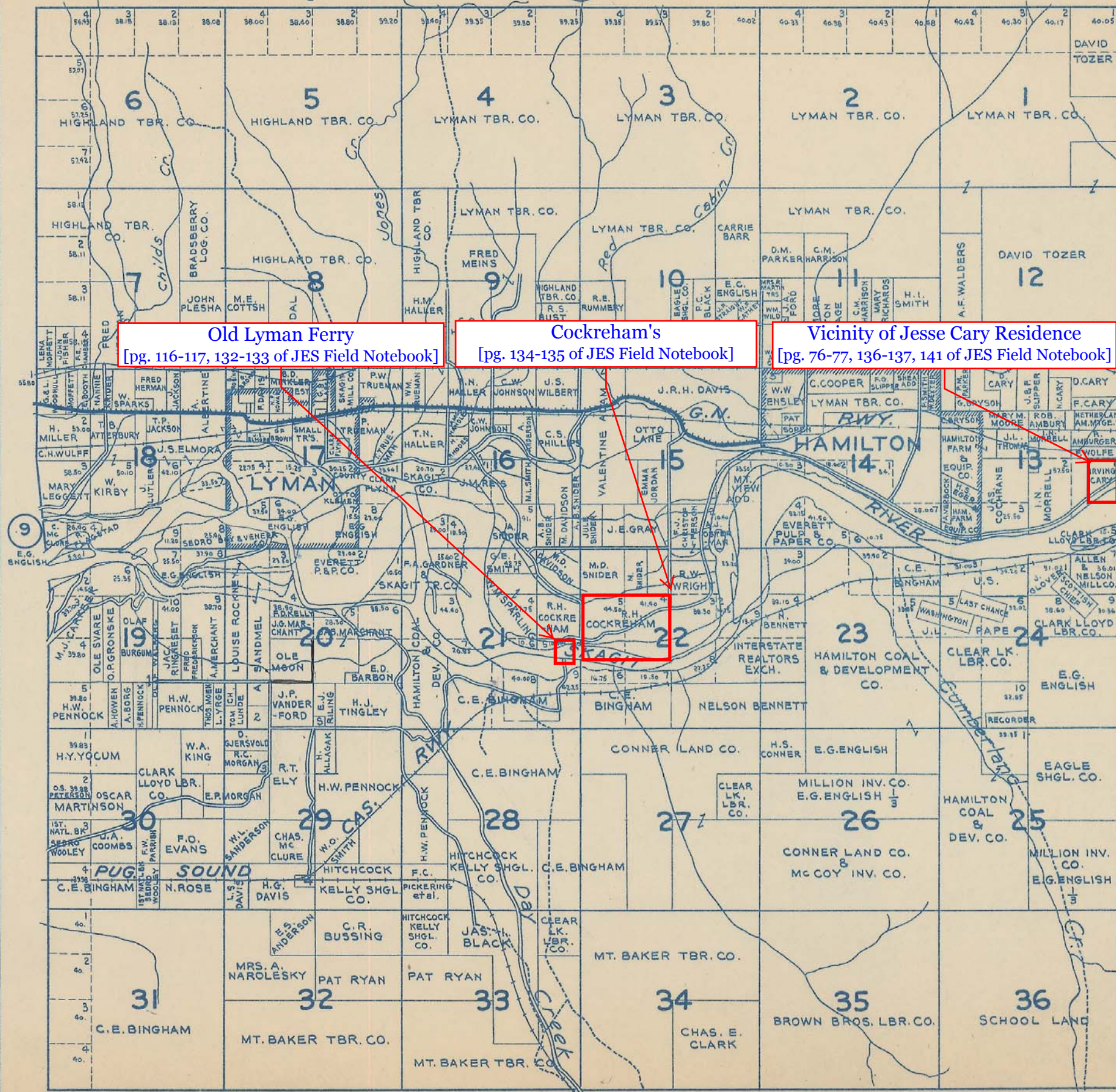

Old Lyman Ferry
[pg. 116-117, 132-133 of JES Field Notebook]

Cockreham's
[pg. 134-135 of JES Field Notebook]

Vicinity of Jesse Cary Residence
[pg. 76-77, 136-137, 141 of JES Field Notebook]

- LEGEND -
- MAIN TRAVELED HWYS
 - PAVED ROADS
 - OTHER ROADS
 - TRAILS
 - RAILROADS
 - ELE. RWYS.
 - SCHOOLS

TOWNSHIP 35 N., RANGE 7 E.W.M. SKAGIT COUNTY

CHAS. F. METSKER CIVIL ENGINEER
930 1/2 PAC. AVE. TACOMA, WASH.

(28)

SCALE 2 IN. = 1 MILE.

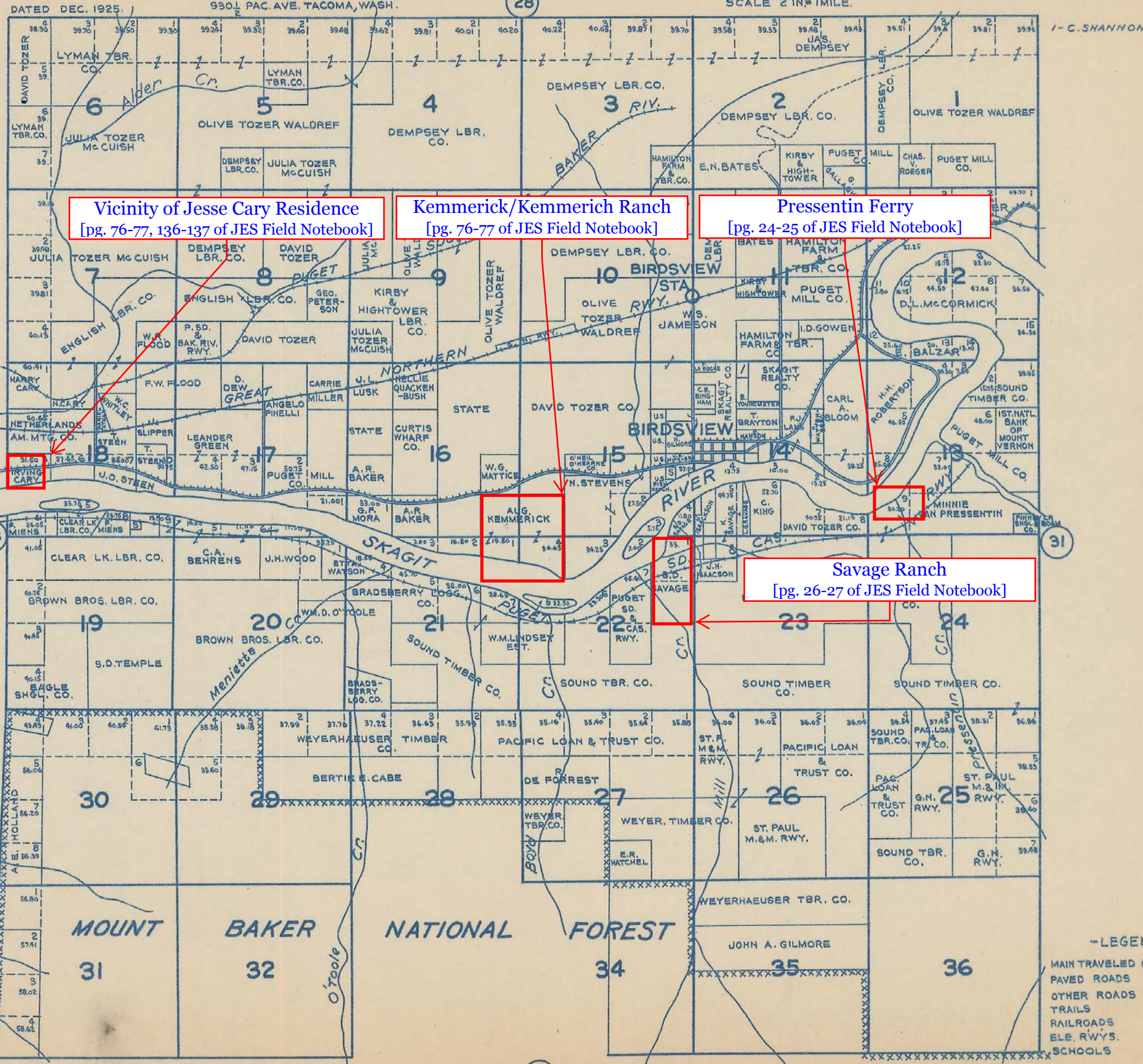

Vicinity of Jesse Cary Residence
[pg. 76-77, 136-137 of JES Field Notebook]

Kemmerick/Kemmerich Ranch
[pg. 76-77 of JES Field Notebook]

Pressentin Ferry
[pg. 24-25 of JES Field Notebook]

IRVING CARY

AUG. KEMMERICK

S.D. SAVAGE

Savage Ranch
[pg. 26-27 of JES Field Notebook]

1 - C. SHANNON

- LEGEND-
- MAIN TRAVELED HWYS.
 - PAVED ROADS
 - OTHER ROADS
 - TRAILS
 - RAILROADS
 - ELE. RWYS.
 - SCHOOLS

(26)

AJS

TOWNSHIP 35 N., RANGE 8 E.W.M.
SKAGIT COUNTY

DATED DEC. 1925.

CHAS. F. METSKER CIVIL ENGINEER
930 1/2 PAC. AVE. TACOMA, WASH.

SCALE 2 IN. = 1 MILE.

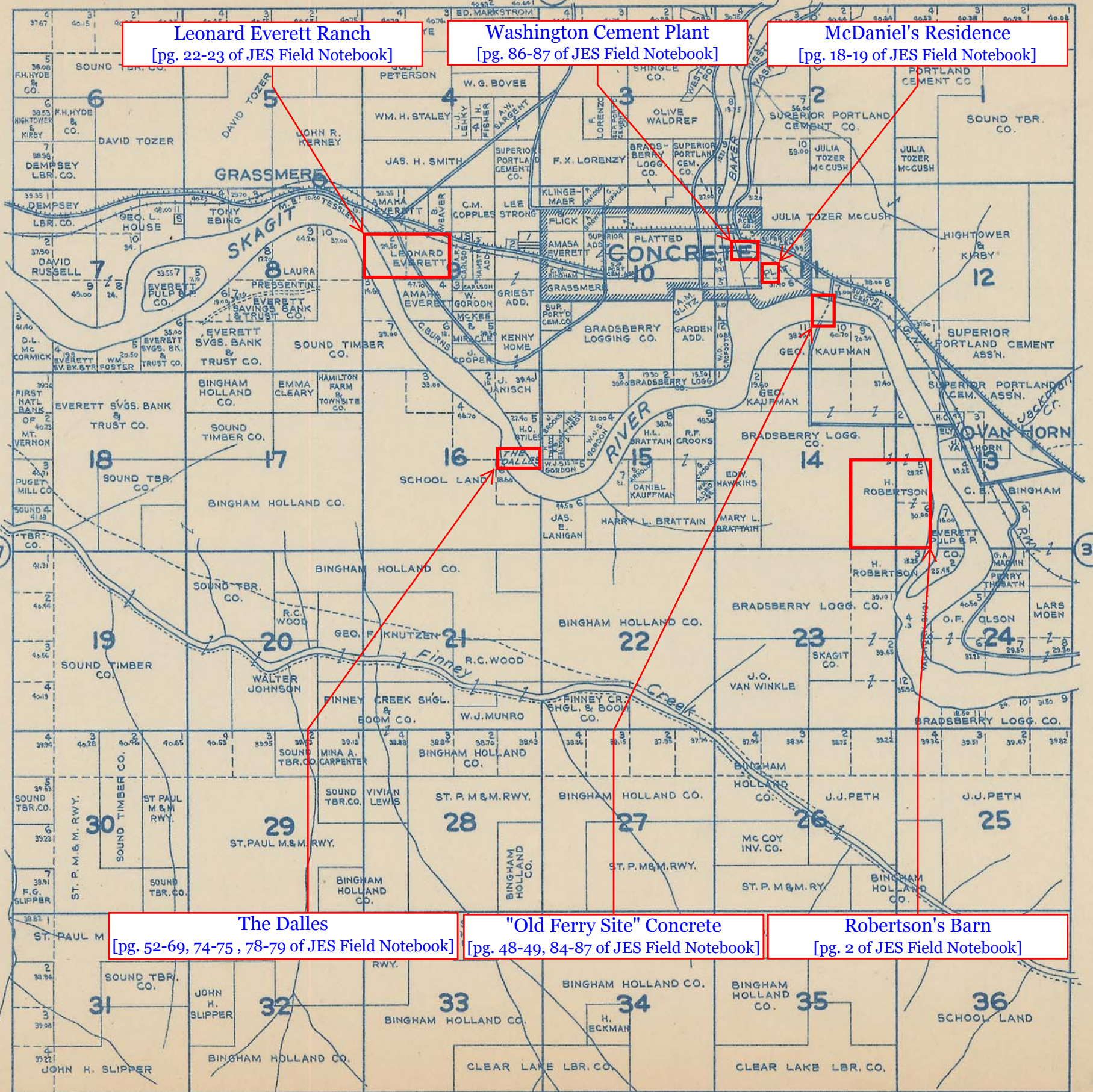

Leonard Everett Ranch
[pg. 22-23 of JES Field Notebook]

Washington Cement Plant
[pg. 86-87 of JES Field Notebook]

McDaniel's Residence
[pg. 18-19 of JES Field Notebook]

The Dalles
[pg. 52-69, 74-75, 78-79 of JES Field Notebook]

'Old Ferry Site' Concrete
[pg. 48-49, 84-87 of JES Field Notebook]

Robertson's Barn
[pg. 2 of JES Field Notebook]

1-M. COOPER
2-BRADBERRY LOGG. CO.
3-C. ANDERSON
4-H.A. ANDERSON

-LEGEND-
MAIN TRAVELED HWYS. [Symbol]
PAVED ROADS [Symbol]
OTHER ROADS [Symbol]
TRAILS [Symbol]
RAILROADS [Symbol]
ELE. RWYS. [Symbol]
SCHOOLS [Symbol]

TOWNSHIP 35 N., RANGE 9 E.W.M. SKAGIT COUNTY

CHAS. F. METSKER CIVIL ENGINEER
930 1/2 PAC. AVE. TACOMA, WASH.
DATED DEC. 1925. SCALE 2 IN. = 1 MILE.

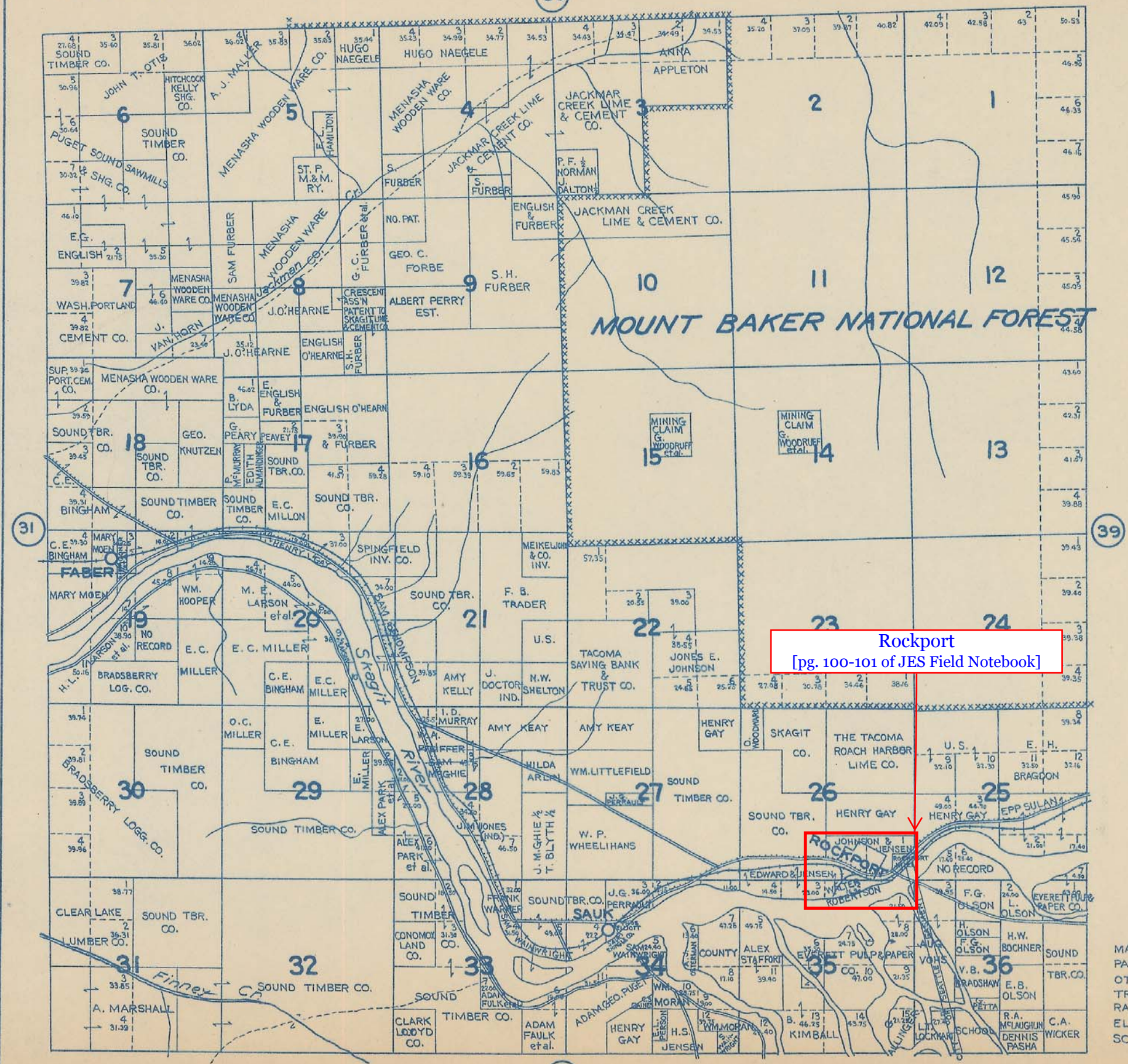

Rockport
[pg. 100-101 of JES Field Notebook]

- LEGEND -
- MAIN TRAVELED HWYS.
 - PAVED ROADS
 - OTHER ROADS
 - TRAILS
 - RAILROADS
 - ELE. RWYS.
 - SCHOOLS

TOWNSHIP 35 N., RANGE 10 E.W.M. SKAGIT COUNTY

CHAS. F. METSKER CIVIL ENGINEER
930 1/2 PAC. AVE. TACOMA, WASH.
DATED DEC. 1925. SCALE 2 IN = 1 MILE.

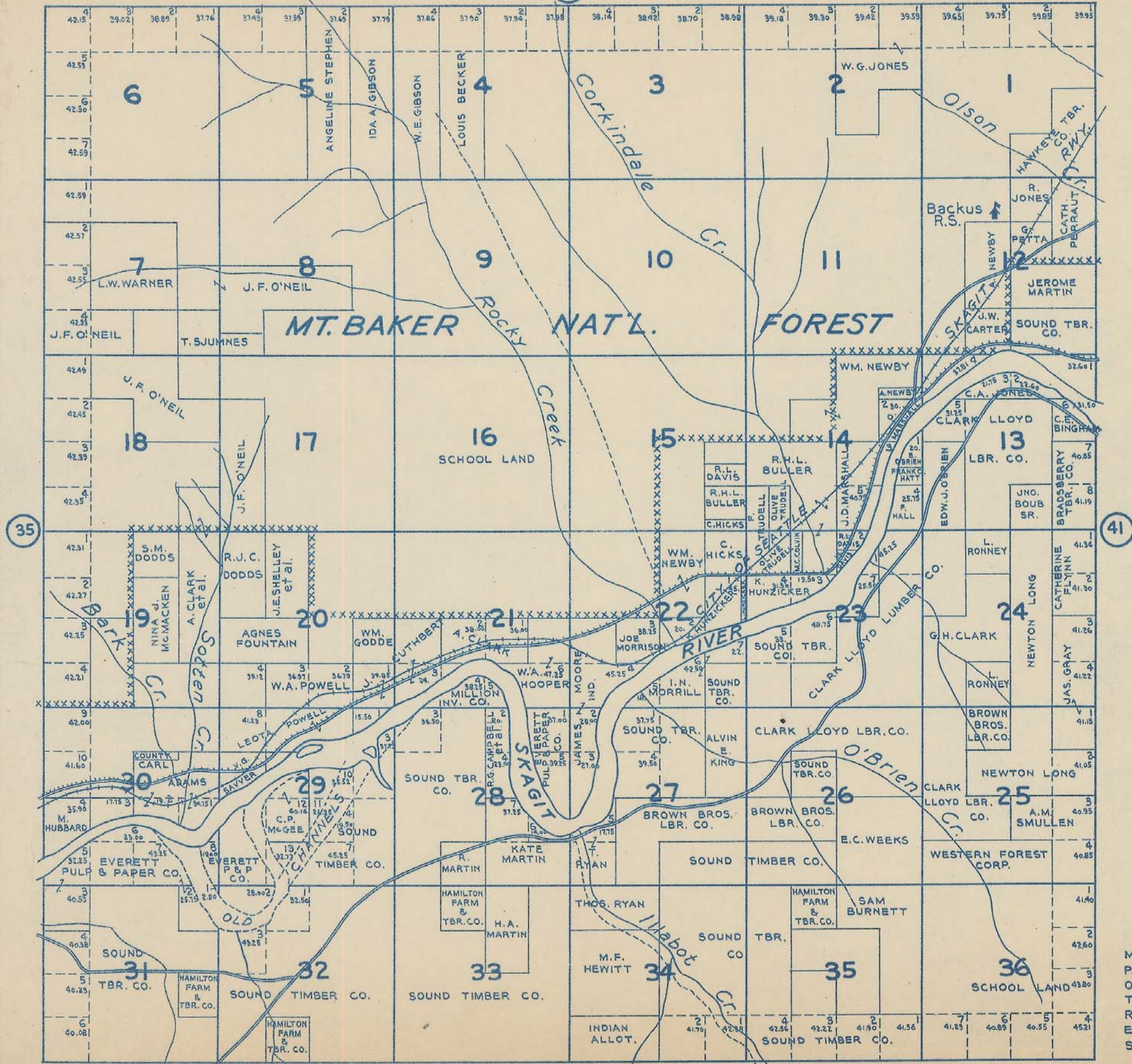

TOWNSHIP 35 N., RANGE 11 E.W.M. SKAGIT COUNTY

CHAS. F. METSKER CIVIL ENGINEER.
930 1/2 PAC. AVE. TACOMA, WASH.

42

SCALE 2 IN = 1 MILE.

DATED DEC. 1925.

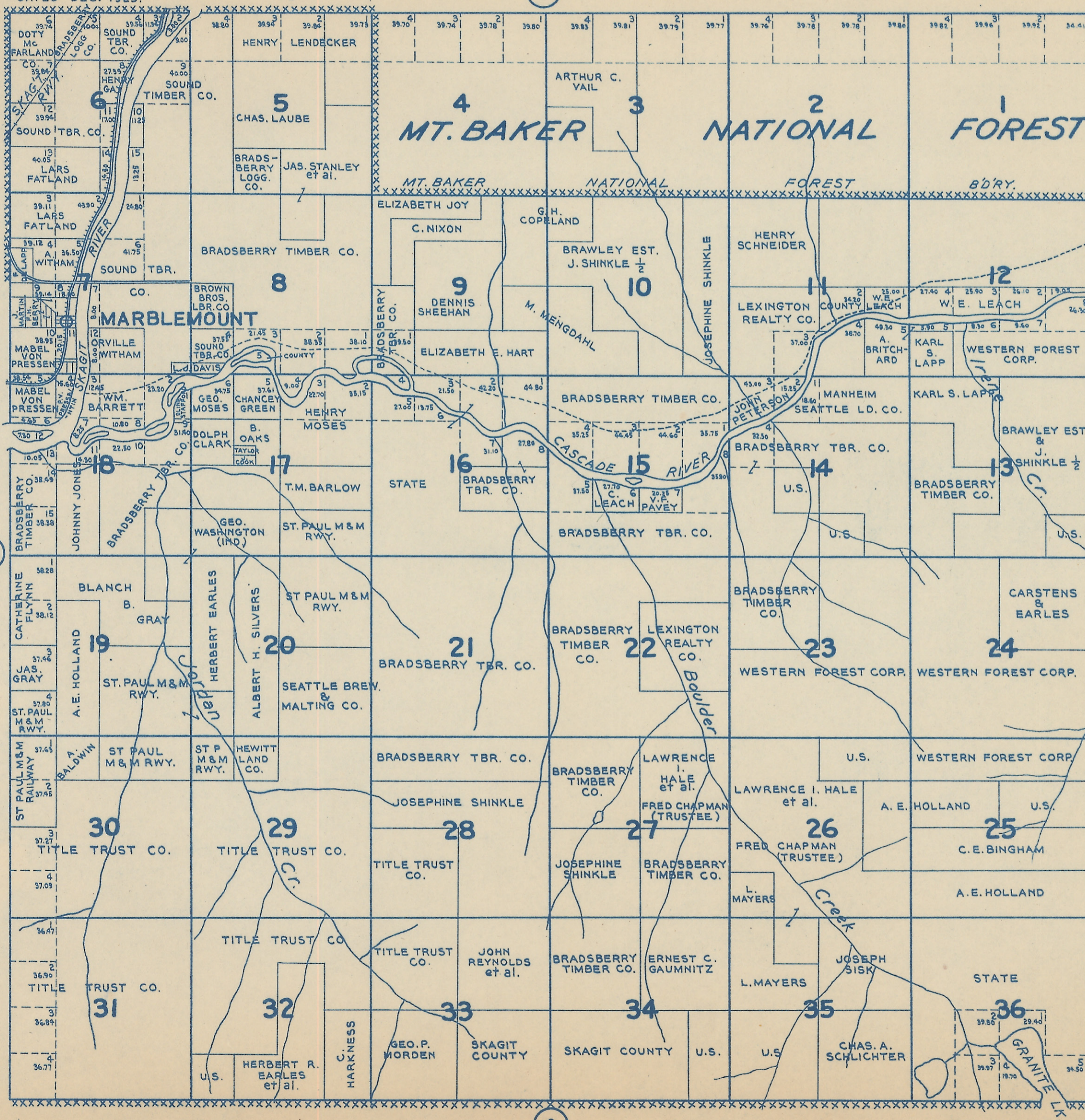

- LEGEND -

- MAIN TRAVELED HWYS.
- PAVED ROADS
- OTHER ROADS
- TRAILS
- RAILROADS
- ELE. RWYS.
- SCHOOLS